

# WET BASEMENTS

Basement Solutions of the Hudson Valley has the expertise to design and install the most efficient and economical groundwater control system for your specific needs.

LICENSED PROFESSIONAL ENGINEERS  
AND CONTRACTORS

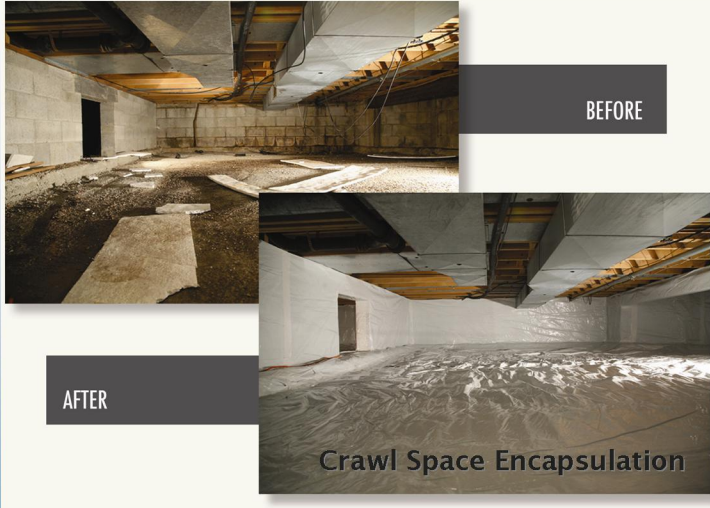

- ☑ SUMP PUMPS WITH BATTERY BACKUP SYSTEMS
- ☑ PERIMETER DRAINS
- ☑ EPOXY CRACK INJECTION
- ☑ POLYURETHANE CRACK INJECTION
- ☑ EXTERIOR FRENCH DRAINS
- ☑ CRAWL SPACE ENCAPSULATION





# Basement Solutions

of the Hudson Valley

## WET BASEMENTS

Basement Solutions of the Hudson Valley has the expertise to design and install the most efficient and economical groundwater control system for your specific needs.



### Moisture Barriers

Moisture barriers are non-porous products applied to the interior of the foundation. All moisture and vapor is prevented from entering the interior of the basement. A basement waterproofed without moisture barriers will continue to have moisture and dampness on the interior walls.

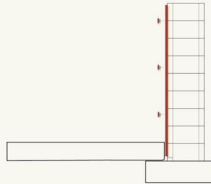

### Diverter

Diverter establish and maintain open water pathways to direct any and all water into a drainage system. Diverter products relieve hydrostatic pressure by facilitating water flow and removing resistance. Waterproofing systems without diverters are easily overwhelmed when heavy rainfall occurs. The volume of incoming water cannot get into the drain fast enough to prevent flooding.

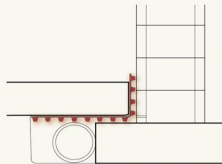

### Drainage

Drainage products are placed under the floor in the basement to collect and discharge all storm water from the basement. It is very important that the drain system can accommodate a high volume of water. An undersized drain system won't be able to handle the demand during heavy rainfall and flooding will occur.

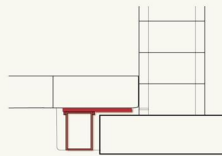

### Sump Pumps

All water must be properly discharged from the drain system. A pumping system is installed to remove all collected water from the structure. It is important to have a pump that is capable of removing the volume of water collected by the system. If a sump pump cannot meet the demands of the system, basement flooding occurs.

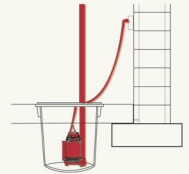

### Back-up Pumps

A backup system takes over pumping duties whenever power service is disrupted. Without a backup system, flooding will occur when power to the home is disrupted. A proper backup system will maintain the required pumping capacity of the system until power is restored.



### Structural Repair

The foundation walls must be inspected for any damage caused by hydrostatic pressure. If there is damage, the integrity of the entire foundation could be at risk. By permanently repairing any damage, the foundation will remain structurally sound.

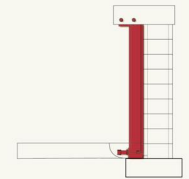

[www.basementshv.com](http://www.basementshv.com)

(845) 564-0461

[info@basementshv.com](mailto:info@basementshv.com)